



ECOLOG-PRO 1THR



TECHNICAL SPECIFICATIONS

Wireless temperature logger with one external combination probe for elproCLOUD & elproMONITOR

ECOLOG-PRO 1THR is an easy and versatile solution to monitor your valuable materials stored in rooms under ambient conditions or in incubators. Battery-operated and wireless, the 868 MHz (Europe, UK, Singapore) or 915 (USA, Australia/ New Zealand) radio band provides excellent reach. Set-up is easy and only takes a few minutes. Simply register the sensor on your elproCLOUD account or your elproMONITOR installation, pair it to an ECOLOG-PRO RBR (radio bridge) communication module, and place it in your room or equipment. A reliable internal storage capacity for thousands of measurements ensures all your valuable data are sent to elproCLOUD or elproMONITOR. Should the connection between the ECOLOG-PRO 1THR and the radio bridge be temporarily lost, the module will automatically search for another radio bridge within range. The elproCLOUD web application aggregates all your sensor data to provide a convenient, comprehensive overview, sending out alerts if alarm limits are breached. ELPRO's industry-leading software elproMONITOR, integrated into your IT infrastructure and database, monitors hundreds or even thousands of monitoring points with wired or wireless sensors.

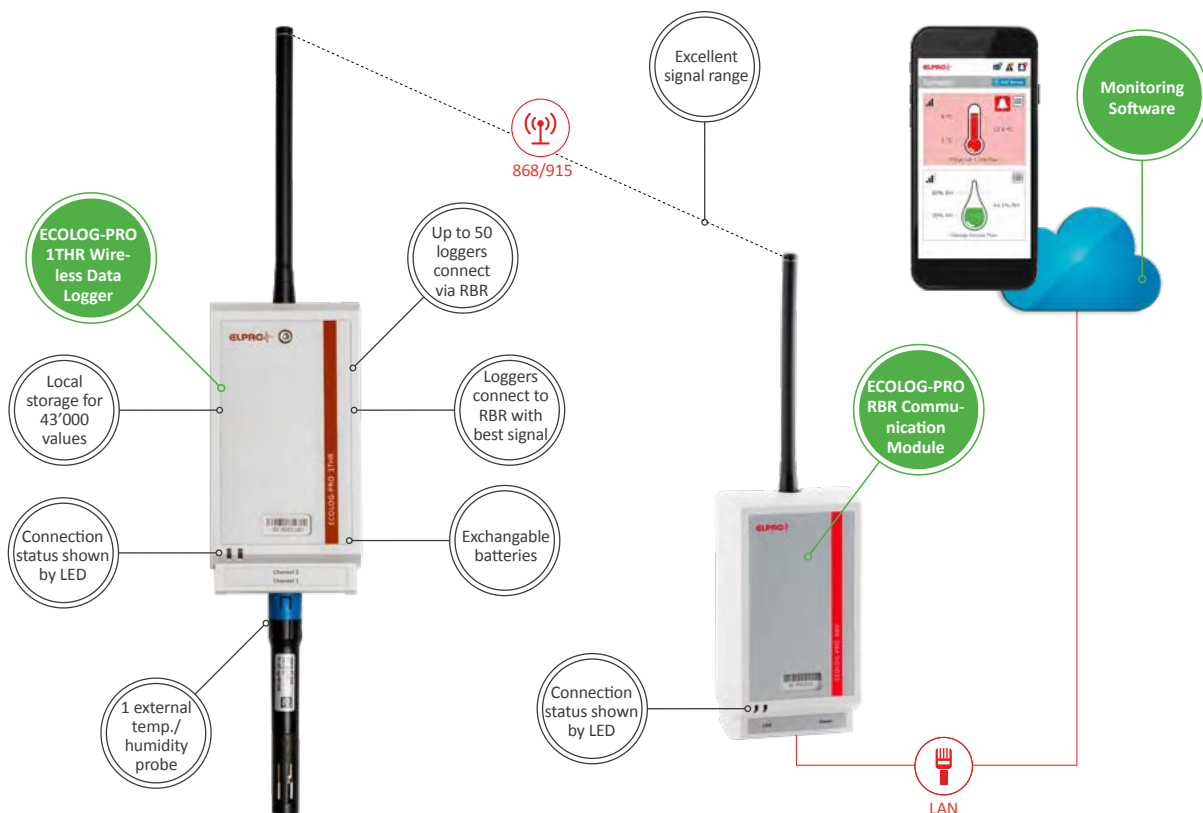



- > Monitors your valuable goods in rooms or incubators
- > Simple, safe and reliable
- > Flexible positioning thanks to radio communication
- > Sensor buffers measurement values to ensure no data is lost in case of temporary interruptions
- > Compatible with elproCLOUD & elproMONITOR

Technical Specifications ECOLOG-PRO 1THR

Type	Wireless temperature/humidity logger
Application area	Temperature monitoring for rooms or incubators
Type of probe	2 channels with separate external connected 3-pin temperature/humidity combination probe
Probe Connection	Digital 3-PIN combination probe Extension: maximum 10 meter cable, no shielding
Measurement range	Temperature: -20.0 °C..+80.0 °C Relative humidity: 20 %RH..80 %RH or 0 %RH..100 %RH (depending on the connected probe)
Measurement accuracy	depending on the connected probe
Measurement resolution	0.1 °C, 0.1 %RH
Calibration Tolerance	For calibration certificate standard tolerances see section 3.1 of the ELPRO Service Description
Measurement interval	1, 2, 3, 5, 10, 15, 20, 30, 60 minutes; user programmable via software (elproCLOUD & elproMONITOR) Note: Logging interval will impact battery life
Measurement capacity	43'000 measurement values
IP protection class	IP20
Battery life	14 months (provided that the module's radio connection is stable and that the defined temperature range is maintained)
Battery type	3 × Alkaline AA
Environmental storage temperature / humidity	-10 °C..+50 °C 10 %RH..90 %RH, non-condensing
Environmental operating temperature / humidity	0 °C..+40 °C 10 %RH..90 %RH, non-condensing
Operating altitude	This device must not be used at altitudes higher than 2000 meters above sea level.
Display	2 LED for communication and measurement status
Certificate	Calibration certificate based on manufacturer calibration standards or ISO 17025 available upon request
Traceability	ID number (traceable to component level)
Report	Via software (elproCLOUD & elproMONITOR)
Case Dimension	ABS plastic material 137 mm (5.39 inch) × 70 mm (2.76 inch) × 57 mm (2.24 inch)
Certifications Conformity	CCE (868 MHz) UKCA (868 MHz) RoHS FCC (915 MHz) ACMA/RCM (915 MHz) IMDA (868 MHz)
Wireless connection to communication module	Available in two versions with 868 MHz or 915 MHz, respectively Note: Only the supplied antenna may be used
Required communication module	ECOLOG-PRO RBR
Declaration of Conformity	https://www.elpro.com/hubfs/fileadmin/Docs/Quality_Documents/ECOLOG-PRO_1THR_DOC_Conformity_1000281V01.pdf https://www.elpro.com/hubfs/fileadmin/Docs/Quality_Documents/20221209_UKCA_DoC_ECOLOG-PRO_Radio.pdf